

# AUTOMATIC VEHICLE IDENTIFICATION(AVI) SYSTEMS FOR FUELING

## 车辆自动加油系统



## Overview

### 产品概述

铭特车辆自动识别(AVI)RFID系统是专为石油公司、车队、加油/加气站和服务供应商等设计的加油方案。此系统包括防爆型RFID识别传感器、无线接收分站及抗金属RFID标签,其具有快捷、易于安装、无线化等特点,可实现快速加油、自助加油、防盗窃及增加利润等功能。

MINGTE automatic vehicle identification (AVI) RFID fueling systems solution is designed for oil companies, fleets, fuel/CNG stations and service providers etc. It enables fast refueling, allows self-service refueling, reduces fraud and helps boost profits. This system is quick, easy to install and completely wireless, creating a great bond between fueling and vehicles. It includes the distinct modules, including Wireless Nozzle Reader, Wireless Receiver and Vehicle Tag etc.

## Features

### 产品特点

- 简单,快捷,安全,智能,无线化,易于安装
- 可有效提高石油公司及车队利润,与加油站控制系统全面整合

- Simple, quick, secure, smart, completely wireless, easy to install
- Various benefits for oil companies and fleets, seamlessly integrate with the station controller

## How Does It Work?

### 如何工作?

- 1: 抗金属标签
- 2: 防爆型RFID识别传感器
- 3: 无线接收分站
- 4: 加油机后台控制系统
- 5: 通讯集线器
- 6: 加油机
- 7: 加油卡

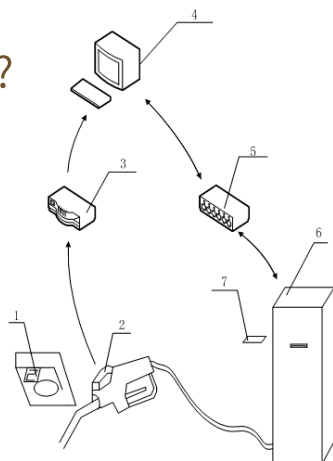

- 1: Vehicle Tag
- 2: Anti-vandal Radio Frequency Nozzle (RFN)
- 3: Wireless Receiver
- 4: Fuel Dispensers Controlling Systems
- 5: Communication Hub
- 6: Fuel Dispensers
- 7: Fuel Card



# 车辆自动加油系统



## Applications 应用

- 车辆自动加油系统  
Vehicle Identification (AVI) System for Fueling
- 加油机、加气机、加油站、加气站、石油公司、天然气公司、车队、服务商  
Fuel Dispensers, CNG Dispensers, Fuel & CNG Stations, Fuel & CNG Company, Fleets, Service Provider

## Steps 操作步骤

- 1: 插入加油卡
- 2: 加油机传输加油卡的信息(例如加油卡号或用户信息)到加油机后台控制系统。
- 3: 插入RFID识别传感器, 验证车辆标签的详细信息(如身份证号码)。
- 4: 车辆标签信息在验证过程中被传输到加油站后台控制系统。
- 5: 当车辆和油枪间的无线通信成功时, 开始加油。
- 6: 加油完成后, 挂枪到加油泵上。
- Insert fuel card.
- Fuel dispensers transmit information (e.g., fuel card No. or user info) in fuel card to fuel dispensers controlling systems.
- Insert radio frequency nozzles, the vehicle tag details (e.g., identification No.) are validated.
- Vehicle tag details are transmitted to petro station controlling systems during authorization process.
- When wireless communication between the vehicle and nozzle is maintained, fuel will be dispensed.
- Once refueling is complete, the nozzle is returned to the pump.

## Components 系统部件



### MT123/RFID识别传感器

MT123是一款防爆型RFID识别传感器, 其读取铭特RFID非接触式AVI车辆标签, 并通过无线接收分站(MT124)将标签信息上传到加油站后台控制系统, 以获取加油授权。本产品具有灵活、安全、防水、防爆、可靠、坚固及易于安装等特点。

### Wireless Nozzle Reader(MT123)

The Wireless Nozzle Reader reads MINGTE AVI vehicle tag info with RFID/contactless technology. It then uploads the tag info to petro station controlling systems over wireless communicator (MT124) for refueling authorization. It is secure & tamper-proof, reliable & robust, easy to install & service and waterproof etc.



### MT124/无线接收分站

MT124是一款基于RFID技术的无线接收分站, 其与RFID识别传感器(MT123)和抗金属标签(MT125)配套使用, 为车辆自动加油系统建立无线网络。本产品灵活、安全、易于安装、设置及升级等特点。

### Wireless Receiver

The wireless receiver builds wireless network with RFID/contactless technology for AVI systems. It works with MINGTE Wireless Nozzle Reader (MT123) and MINGTE Vehicle Tag (MT125). It is flexible, secure and easy to install & setup & upgrade etc.



### MT125/抗金属标签

MT125是一款专门针对加油环境而设计的高性能迷你型抗金属电子标签, 其与RFID识别传感器(MT123)和无线接收分站(MT124)配套使用。本产品符合ISO18000-6C协议, 具有安全、抗冲击、易于安装及防盗保护等功能。

### Vehicle Tag

The vehicle tag is a lightweight identification unit designed for fuel inlet working environment. It works with MINGTE Wireless Nozzle Reader (MT123) & Wireless Receiver(MT124). It is secure, tamper-proof, easy to install, complies with ISO18000-6C protocol and has anti-theft protection function.

深圳市铭特科技有限公司  
SHENZHEN MINGTE TECH CO., LTD.

地址: 深圳市南山区高新园北区航天微电机大厦科研楼四楼南侧  
邮编: 518057  
电话: +86-755-86030926(国内销售部)  
传真: +86-755-86030955  
邮箱: sales@mingte.cn  
网址: www.mingtetech.com

Add: 4/F, Aerospace Micromotor Building, High-tech Industrial Park  
North, Nanshan District, Shenzhen, China  
Postcode: 518057  
Tel: +86-755-86232730(Sales Dept.)  
Fax: +86-755-86030955  
E-mail: sales@mingte.cn  
Website: www.mingtetech.com

