

# PT100

## RECEIPT PRINTERS

### 票据打印机



## Overview

### 产品概述

PT100是一款高速的工业级热敏打印机，支持58mm纸宽，配有高可靠性的自动切刀。该打印机是专门针对加油站及加气站环境设计的，符合IP54标准。具备自动切纸、自检、走纸及错误状态提示等功能。该产品在多种领域中得到广泛的应用，包括自助终端机、加油机、加气机、停车场系统、自助售票机和自动售货机。

PT100 is a fast (up to 120mm/sec) thermal industrial receipt printer with 58mm paper width and highly reliable automatic cutter. The printer is specially designed for fuel & gas station environment with IP54 compliant. It has automatic cutting, self-check, paper feeding and error status indication functions. It is widely used in various fields, including Kiosk Terminals, Fuel Dispensers, CNG Dispensers, Parking Systems, Ticketing Machines, and Vending Machines etc.

## Features

### 产品特点

- 安全性高、稳定性好
- 热敏打印功能
- 有效打印宽度: 48/54mm(可通过控制命令选择)
- 打印质量高、打印速度快(可达120mm每秒)
- 自动切刀质量可靠, 100万次以上寿命
- 打印机自检功能, 状态监控功能
- 可根据用户需求定制各种接口
- 具有防风雨(符合IP54)、防灰尘功能、环境适应性好
- 专门针对加油站及加气站环境设计

- High reliability and durability
- Thermal printing
- Printing width: 48/54mm (options by commands)
- Printing with high graphic quality & speed (speed up to 120m m/sec)
- Highly reliable automatic cutter, over 1000000 cuts
- With self-test and full status monitor function
- Various interface (customized)
- Weather-proof (IP54 compliant), dust-proof, environmental adaptability
- Specially designed for fuel & gas station environment



# PT100



## Applications

### 应用

自助终端机 / 加油机 / 加气机 / 停车场系统 / 自助售票机 / 自动售货机

Kiosk Terminals / Fuel Dispensers / CNG Dispensers / Parking Systems / Ticketing Machines / Vending Machines

## Specifications

### 性能指标

打印方式 / Printing Method	热敏打印 / Thermal Printing
打印密度 / Printing Resolution	384/432 dpi(8 dots/mm)
打印速度 / Printing Speed	>120mm/sec
有效打印宽度 / Printing Width	48/54 mm
打印纸 / Printing Paper	最大外径 / Max External Diameter: 50mm      内径 / Internal Diameter: 12.5mm 纸宽 / Paper Width: 57.5±0.5mm      纸厚 / Paper Thickness: 65±0.5um
每行字符数 / Character Per Line	12x24 dots(32 characters)
打印控制命令 / Emulation	ESC/POS
接口 / Interface	RS232
波特率 / Baud Rate	9600/19200bps
电源 / Power Supply	DC24V ± 5%
工作电流 / Current	≤2A(+24V)
数据缓冲区 / Data Buffer	8K
操作系统 / Operating System	Windows
工作温度 / Working Temperature	-40+70°C
打印头寿命 / Printing Head Life	100KM/100M 脉冲 / Pulses
重量 / Weight	约642g / Approx 642g
备注 / Remark	防风雨 / Weather-proof

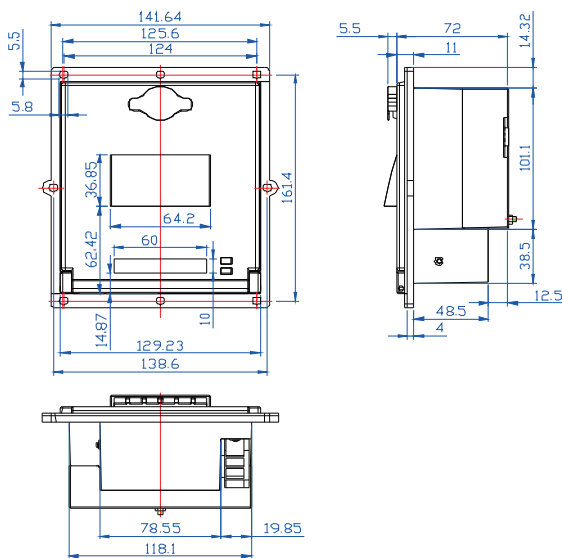

深圳市铭特科技有限公司  
SHENZHEN MINGTE TECH CO., LTD.

地址: 深圳市南山区高新园北区航天微电机大厦科研楼四楼南侧  
邮编: 518057  
电话: +86-755-86030926(国内销售部)  
传真: +86-755-86030955  
邮箱: sales@mingte.cn  
网址: www.mingtetech.com

Add: 4/F, Aerospace Micromotor Building, High-tech Industrial Park  
North, Nanshan District, Shenzhen, China  
Postcode: 518057  
Tel: +86-755-86232730(Sales Dept.)  
Fax: +86-755-86030955  
E-mail: sales@mingte.cn  
Website: www.mingtetech.com

